

CHICAGO, ILLINOIS

May 28 & 29, 2016

MIDWEST SACRED HARP SINGING CONVENTION

**Two full days of
shape-note singing.**

9:30 am - 3:00 pm both days.

Saturday, May 28

PULASKI PARK FIELDHOUSE, 1419 W. BLACKHAWK ST.

Sunday, May 29

IRISH AMERICAN HERITAGE CENTER, 4626 N. KNOX ST.

Dinner on the grounds.

Potluck both days at noon.

Local singers, please bring at least one large homemade dish to pass!

For housing, contact Cathryn Bearov, (773) 398-5398 or bcathryn@netscape.net.
Other inquiries: Co-chairs Mary Rogel and Jerry Gripshover, (773) 752-0542;
mjrogel@earthlink.net or jgripsho@sbcglobal.net

We encourage everyone to sing with us.

Tunebooks available for loan or purchase.

All are welcome!

FREE!!

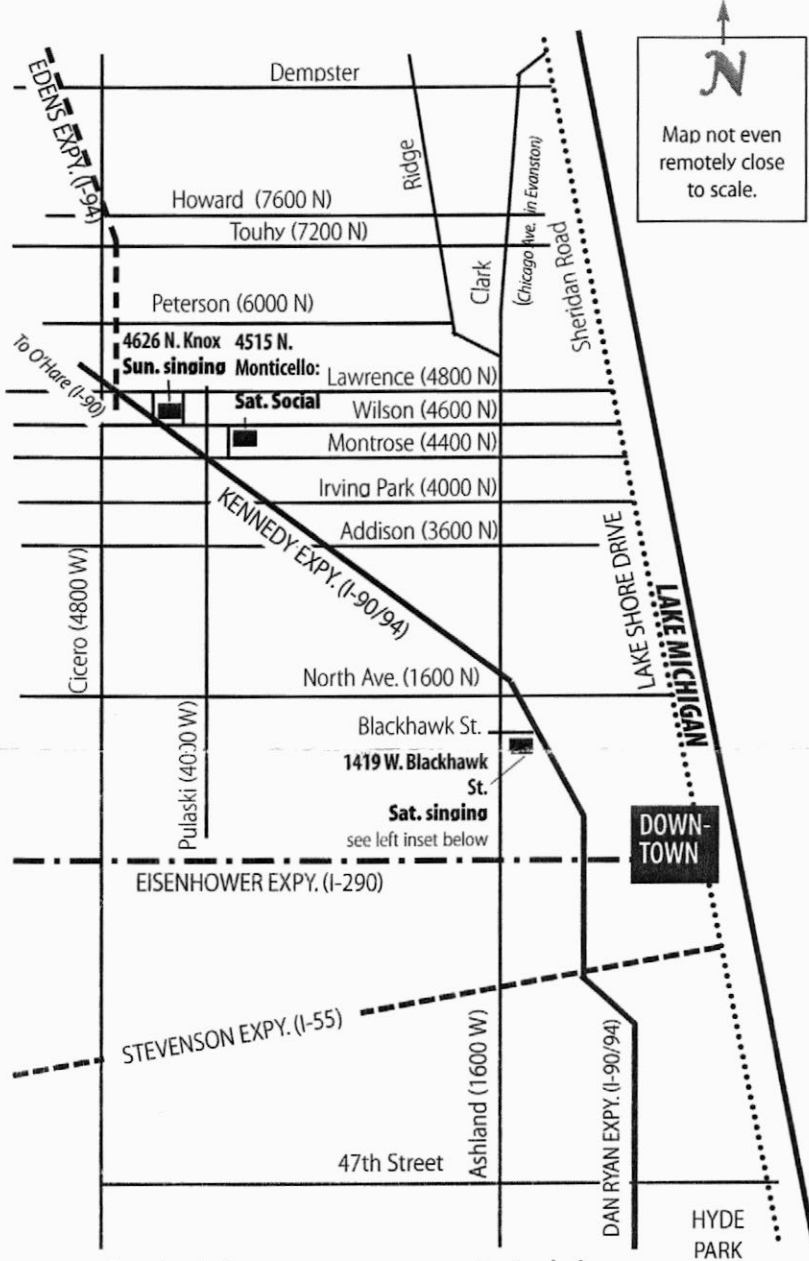

Map not even remotely close to scale.

Driving directions to the Saturday singing:

Pulaski Park Fieldhouse (1419 W. Blackhawk St.) is not far from the North Avenue exit on I-90/94. Head west on North Avenue two blocks to Ashland Avenue, the first light after the exit. Turn left on Ashland. Go south two blocks to Blackhawk; turn left. Drive five short blocks to the Fieldhouse, which will be on the right side of the street. You can drop off food and/or passengers outside the fieldhouse. Park on the street or at the Rowe School lots north of Blackhawk Street between Cleaver and Greenview.

From Lake Shore Drive (north or south): Exit at North Avenue. Head west about 1.5 miles to Ashland Avenue, then follow directions above.

Driving directions to the Sunday singing:

The Irish American Heritage Center (4626 N. Knox Ave.) is on Chicago's northwest side, near the I-90/I-94 split. You can park in the lot.

From I-90, heading south: Take I-90 E to Lawrence Ave in Chicago. Take exit 84. Turn left onto Lawrence; go 0.6 mi (you'll pass I-94); turn right onto Kilpatrick; drive 1.5 blocks to IAHC on your left.

From I-94, heading south: Take I-94 E to Cicero Ave (exit 41C). Continue south on Cicero to Wilson; turn left on Wilson to Knox, then turn left on Knox to IAHC on your left.

From I-90/94, heading north: Take I-90 /I-94 W to Wilson Ave (exit 43A). Turn right onto Wilson; go 1 block to Knox. Turn left; building will be on your left.

From Lake Shore Drive (north or south): Exit at Lawrence Avenue. Head west on Lawrence about three miles. Turn left on Kilpatrick; go 1.5 blocks to IAHC.

Public transportation:

Both locations are near stops on the Blue Line CTA trains from downtown and O'Hare. Saturday's singing is two blocks east and two blocks north of the Division station; Sunday's is two blocks north of the Montrose station. Saturday's singing is also near the North Avenue, Ashland, and Division bus lines. Sunday's singing is near the Montrose and Lawrence Avenue lines, also about 0.7 miles from the Kimball stop on the Brown Line train.

Bike tips:

Saturday: There is a bike lane on Elston Avenue. Exit at North Avenue, head west; turn left on Ashland. Go two blocks south to Blackhawk St.; turn left and ride five blocks to the fieldhouse.

Sunday: There is a bike lane for a long stretch of Lawrence Avenue. (Wilson Ave. may be more scenic, but it is very narrow at some of its busiest points.) Turn south on Kilpatrick and ride two blocks to the IAHC.

Saturday singing:
1419 W. Blackhawk Street



*Parking is available in the east and west lots at Rowe School.

Sunday singing:
4626 N. Knox Avenue



Knox is one-way headed north. Kilpatrick is one-way headed south.

Poster and map design:
Lisa Grayson

Chicago Sacred Harp Singers
c/o Caroline Presnell
9360 Skokie Blvd., Apt. 517
Skokie, Illinois 60077

S SUBURBAN IL 604

26 APR 2016 PM 10 L

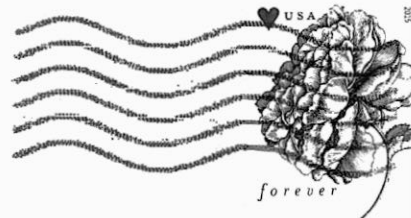

May 28 & 29, 2016
MIDWEST
SACRED HARP SINGING
CONVENTION

40064204515

